

SIMPLE INSTALLATION

Bellagard Sculpted Wall Panel's unique interlocking panel edge system provides a complete installation solution that eliminates guesswork. This wall system arrives on the job site pre-cut, pre-finished, and ready to install. Unpack the panels and attach in three easy steps.

Bellagard Sculpted Wall Panels transform any project into a work of art.

INSTALLATION INSTRUCTIONS

1. LEVEL

Mark lines on wall.

2. TRIGGER

Apply appropriate adhesive and screw to substrate.

3. ATTACH

Snap in Klick clips and snap on trim.

2 ATTACH PANELS Screw Panel(s) to Substrate

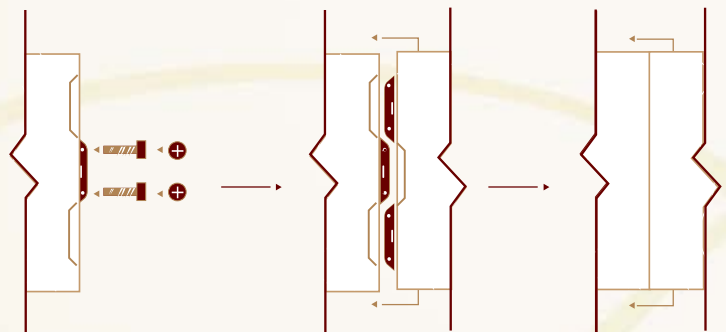

1 PLUMB A LINE Snap a Line

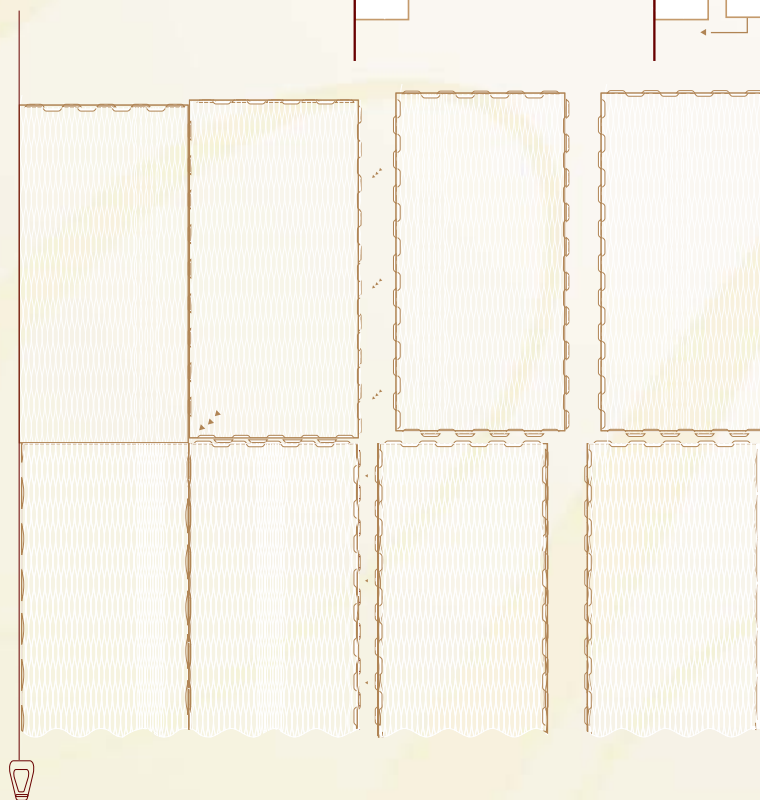

3 TRIM Snap on Trim

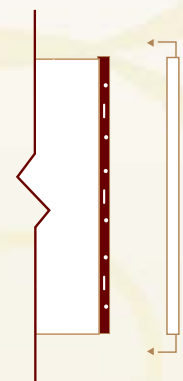

Bellagard Sculpted Wall Panels create an exciting, eye-catching way to dress-up your interior.

NO HIDDEN CHARGES

HOW DOES BELLAGARD COMPARE TO THE COMPETITION?	BELLAGARD	OTHERS
SHOP DRAWINGS, TO INCLUDE A LAYOUT FOR EACH WALL	STANDARD	UP-CHARGE
PANELS AND TRIM MILLED, CUT TO SIZE AND NUMBERED	STANDARD	UP-CHARGE
PATTERN-MATCHING FROM ONE PANEL TO THE NEXT	STANDARD	UP-CHARGE
LABOR SAVING INTERLOCKING TAB AND KLIK CLIP MOUNTING SYSTEM	STANDARD	UP-CHARGE
COMPLETE INSTALLATION INSTRUCTIONS FOR PATENTED MOUNTING SYSTEM	STANDARD	UP-CHARGE
WALL-DOG™ ANCHORS FOR ATTACHING TO GYPSUM AND PLYWOOD SUBSTRATES <small>(NO NEED TO LOCATE STUDS)</small>	STANDARD	UP-CHARGE
QUICK KLIK CLIPS TO SNAP ON TRIM	STANDARD	UP-CHARGE
PRODUCTS THAT CONTRIBUTE TO BUILDINGS ACHIEVING LEED POINTS	STANDARD	UP-CHARGE

PRECAUTIONS

1. Do not over tighten Wall-Dog™ anchors.
2. Avoid power sources, ventilation ducts, and water pipes.
3. Be careful when using screwdriver on Klick clips to avoid scratching the panel.
4. Do not install Klick clips before mounting the panel to the wall.

INCLUDED



Installation plans



Wall-Dog™ anchors



Klick clips

(Coffee cup and pennies not included.)

Recommended construction adhesive appropriate to the job or region.

REQUIRED



Large flat-blade screwdriver for installing Klick clips



Level, laser, or plumb-line



Cordless drill or sheetrock screwgun

