

KICKPLATES AND PUSHPLATES

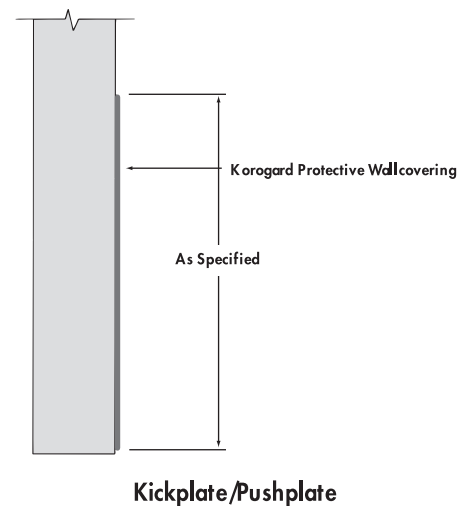

Korogard Kickplates and Pushplates provide doors with unmatched protection against constant abuse from mobile equipment and pedestrian traffic. Korogard Kickplates and Pushplates are custom-made to meet your specific requirements and can be produced as "L" shapes to protect door edges. Korogard Kickplates and Pushplates are available in all standard Korogard colors and thicknesses, as well as stainless steel in a #4 satin finish or one of five textured pattern options. Korogard Kickplates and Pushplates are backed by a limited five-year warranty. They are chemical- and stain-resistant to prevent discoloration and surface damage.

Kickplates and Pushplates are fire rated for Surface Burning Characteristics as classified by Underwriters Laboratories, Inc. and meet national building code standards. All Korogard protective products color-coordinate with a multitude of Koroseal Wallcoverings for a systems approach to wall protection. For more information on Korogard Kickplates and Pushplates or the Koroseal Wall Protection System, please call your local Korogard distributor.



SECTION 10 26 00 DOOR PROTECTION

PART 1 GENERAL

1.01 SECTION INCLUDES

- A. Door Kickplates.
- B. Door Pushplates.

1.02 SUBMITTALS

- A. Comply with requirements of Section 01 33 00—Submittals.
- B. Product Data: Submit manufacturer's product data.
- C. Samples: Submit 7" (177.8mm) x 9" (228.6mm) sample of each type, thickness, color, and texture to be installed for Architect's approval.

1.03 DELIVERY, STORAGE, AND HANDLING

- A. Delivery: Deliver materials to site in manufacturer's original, unopened containers and packaging with labels clearly indicating manufacturer and material.
- B. Storage: Store materials indoors in a clean, dry area protected from damage and in accordance with manufacturer's instructions.
- C. Handling: Protect materials during handling and installation to prevent damage.

1.04 ENVIRONMENTAL REQUIREMENTS

- A. Maintain constant minimum air temperature of 65°F (18°C) for a minimum of 48 hours before and during installation.
- B. Maintain door surface temperature between 65°F (18°C) and 85°F (29°C) during installation.
- C. Do not install if relative humidity is greater than 80%.

PART 2 PRODUCTS

2.01 MANUFACTURER

Koroseal Wall Protection Systems,
A Division of RJF International Corporation.

2.02 DOOR PROTECTION

- A. Koroseal "Korogard" Door Kickplates:
Rigid high-impact door kickplates.
 - 1. Fire Rating: [Class A] [Class B].
 - 2. Thickness: Standard—[0.028" (0.71mm)] [0.040" (1.02mm)] [0.060" (1.52mm)]; Custom—[0.080" (2.03mm)] [0.125" (3.18mm)].
 - 3. Width: _____.
 - 4. Height: _____.
 - 5. Edges: [Square] [Beveled].
 - 6. Backing: [Adhesive backing] [Unbacked].
 - 7. Color: Color to be selected by Architect from manufacturer's standard colors.

- B. Koroseal "Korogard" Door Pushplates: Rigid high-impact door pushplates.

- 1. Fire Rating: [Class A] [Class B].
- 2. Thickness: [0.028" (0.71mm)] [0.040" (1.02mm)] [0.060" (1.52mm)] [0.080" (2.03mm)] [0.125" (3.18mm)].
- 3. Width: _____.
- 4. Height: _____.
- 5. Edges: [Square] [Beveled].
- 6. Backing: [Adhesive backing] [Unbacked].
- 7. Color: Color to be selected by Architect from manufacturer's standard colors.

- C. Koroseal "Korogard" Stainless Steel Door [Kickplates] [Pushplates]: Type 304 SST Door protection.

- 1. Thickness: [14GA] [16GA] [18GA].
- 2. Width: _____.
- 3. Height: _____.
- 4. Finish: #4 Satin.
- 5. Attachment Holes: [Required] [Not Required].

2.03 ADHESIVES

Furnish adhesives approved by wall and door protection manufacturer.

PART 3 EXECUTION

3.01 EXAMINATION

Inspect surfaces to receive door protection. Notify the Architect in writing if wall surfaces are not acceptable. Do not begin installation until unacceptable conditions have been corrected.

3.02 SURFACE PREPARATION

Prepare surfaces in accordance with manufacturer's written instructions.

3.03 INSTALLATION

- A. Install door protection in accordance with manufacturer's written instructions.
- B. Allow door protection and adhesives to precondition for a minimum of 24 hours at a temperature between 65°F (18°C) and 85°F (29°C) before installation.
- C. Install door protection level, plumb, and at height as indicated on the drawings, with surfaces free from distortion.

3.04 CLEANING

- A. Clean door protection in accordance with manufacturer's instructions.
- B. Remove excess adhesive.